



## INFRARED SAUNA JI130

### Specifications and assembly instructions

#### SPECIFICATIONS



Model	Ji130
Dimensions	1300x1050x1900 mm
Number of persons	2
Wood	Pine, heat treated, 48 mm
Glass	Transparent, tempered, 8 mm
Hinges	INOX
Control	Control panel with buttons
Operating time	Up to 90 min
Temperature	Up to 65 °C
Ventilation	Yes
Connectivity	USB, Bluetooth, Radio, App
Lighting	LED RGB starry sky
Heaters	1750 W
Connection	Schuko socket 230 V, 50 Hz, 16 A fuse
Weight	146 kg

## COMPONENTS

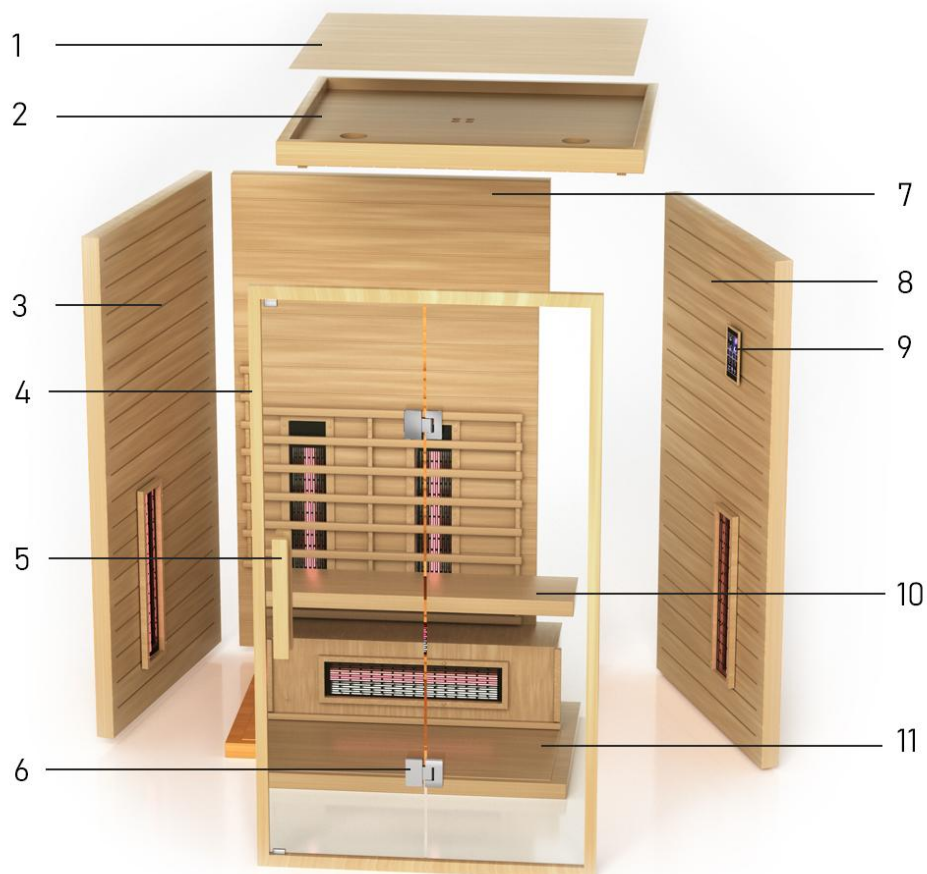

1 Cover plate

2 Ceiling panel

3 Left side

4 Front panel with glass

5 Handles

6 Hinge

7 Back plate

8 Right side

9 Control panel

10 Bench

11 Bottom

## RECOMMENDED TOOLS



Screwdriver



Meter



Screwdriver



Screws



Water scale



Imbus key



Knife



Ladder

## ASSEMBLY TIPS

Please remove the transport packaging and check that your infrared sauna has been delivered complete and undamaged before starting assembly. At least two people are needed to assemble the sauna.



## ASSEMBLY STEPS



1. Bottom



2. Back side



3. Left side



4. Bench



5. Right side



6. Ceiling panel



7. Front panel with glass



8. Cover plate



9. Handle



## Installing the outer buckle

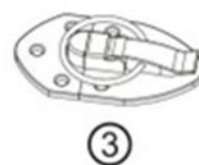
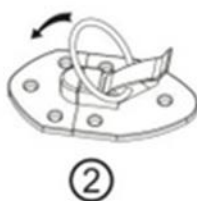
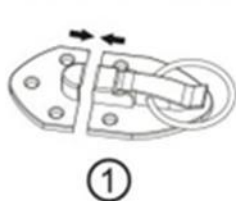

## Connecting electrical components



1. Connect the power cable under the bench (for saunas with lower and floor heaters).

2. Connect the blue UTP cable from the control panel to the sauna control unit.

3. Connect the power cables between the control unit and the stove.

## Installation of hinges, handle and cover



1. Install the hinges

2. Install the handle

3. Install the cover plate

